

Mary Curry

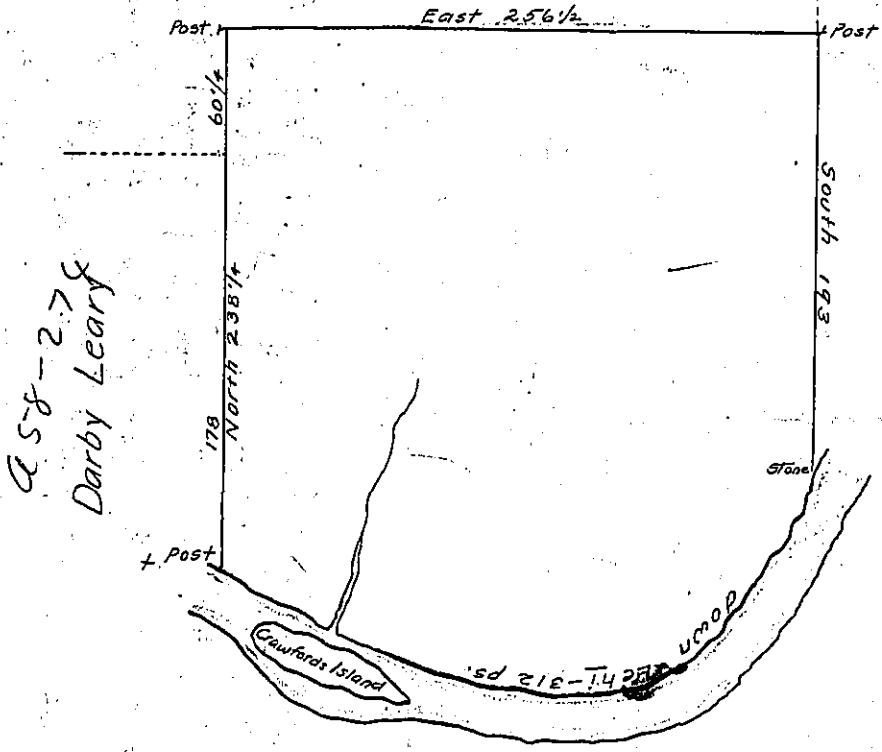

Thomas Dyer Esqr.

- Bearing & dis^c down
Lehi-arc
- ✓ 1. S. 33. W. 82
 - ✓ 2. S. 55. W. 38
 - ✓ 3. S. 80. W. 24
 - ✓ 4. N. 87. W. 42
 - 5. N. 79. W. 40
 - ✓ 6. N. 65. W. 40
 - ✓ 7. N. 60. W. 46
- 312

A 58-27
Darby Leary

By Virtue of a Warrant dated the 11th. September 1784 Surveyed the
 27 October 1784 to Robert Curry the above described tract of land situate
 on the West side of Lehi-in Northampton County Containing four hun-
 dred and one Acres one hundred and twenty seven perches and the
 allowance of Six pCent &c^a

p-Geo. Palmer

John Lukens Esqr. }
 Surveyor General }

IN TESTIMONY that the above is a copy of the original remaining on file in
 the Department of Internal Affairs of Pennsylvania, made
 conformably to an Act of Assembly approved the 16th day of
 February, 1833, I have hereunto set my Hand and caused
 the Seal of said Department to be affixed at Harrisburg,
 this twentieth day of September 1904



Joac P. Brown
 Secretary of Internal Affairs